

5

#5-Main

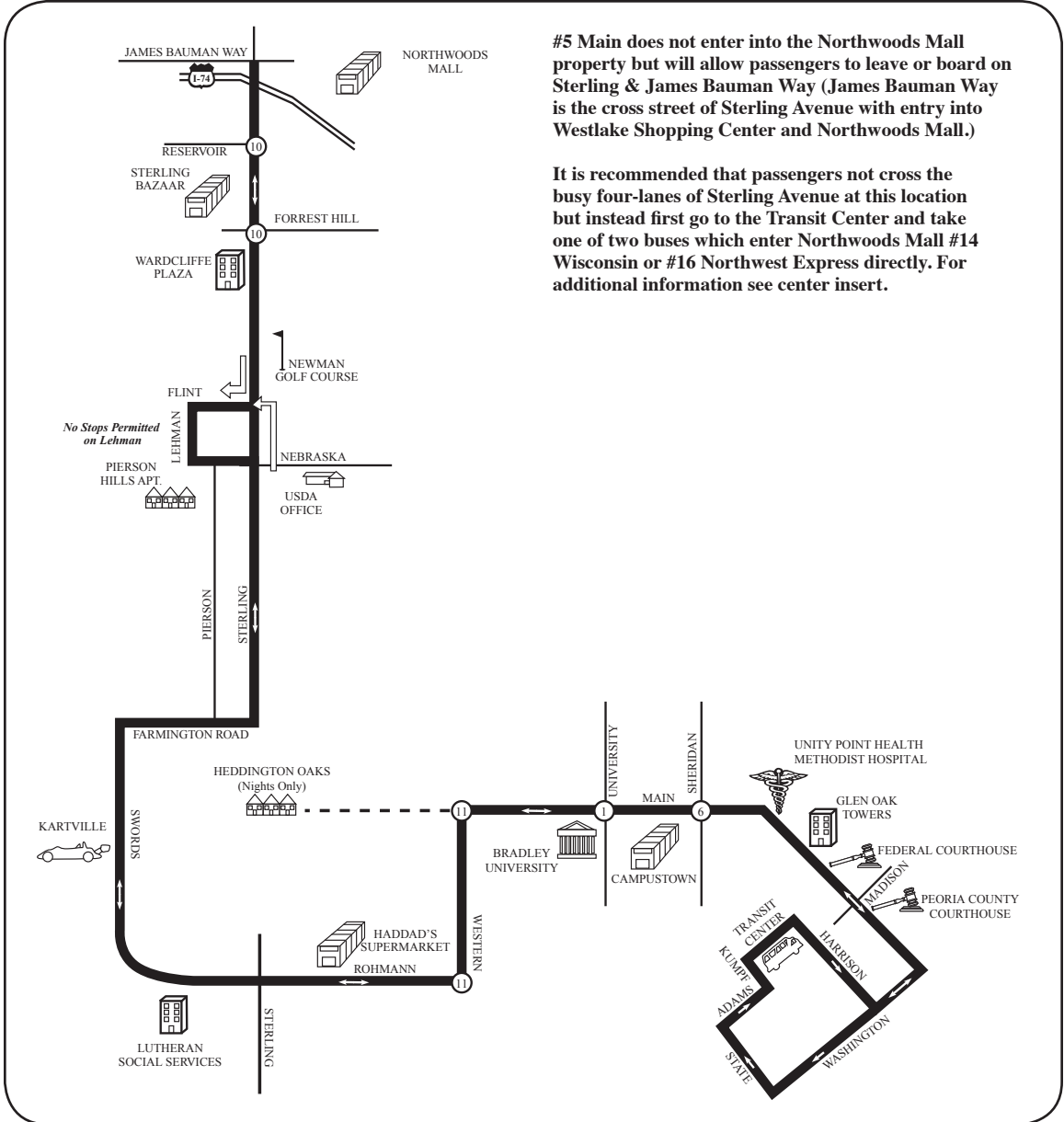

#5 Main does not enter into the Northwoods Mall property but will allow passengers to leave or board on Sterling & James Bauman Way (James Bauman Way is the cross street of Sterling Avenue with entry into Westlake Shopping Center and Northwoods Mall.)

It is recommended that passengers not cross the busy four-lanes of Sterling Avenue at this location but instead first go to the Transit Center and take one of two buses which enter Northwoods Mall #14 Wisconsin or #16 Northwest Express directly. For additional information see center insert.

#5-MAIN

Times are approximate and may vary due to weather, road, and traffic conditions.

LEAVE TRANSIT CENTER	MAIN & UNIVERSITY	ROHMANN & STERLING	PIERSON & NEBRASKA	STERLING & BAUMAN WAY	STERLING & BAUMAN WAY	PIERSON & NEBRASKA	ROHMANN & STERLING	MAIN & UNIVERSITY	ARRIVE TRANSIT CENTER
MONDAY thru FRIDAY									
			FROM GARAGE		5:34	5:42	5:50	5:55	6:05
			FROM GARAGE		6:04	6:12	6:20	6:25	6:35
6:15	6:25	6:30	6:38	6:46	6:39	6:47	6:55	7:00	7:10
6:45	6:55	7:00	7:08	7:16	7:09	7:17	7:25	7:30	7:40
7:15	7:25	7:30	7:38	7:46	7:34	7:42	7:50	7:55	8:05
7:45	7:55	8:00	8:08	8:16	8:04	8:12	8:20	8:25	8:35
8:15	8:25	8:30	8:38	8:46G	8:34	8:42	8:50	8:55	9:05
8:45	8:55	9:00	9:08	9:16G					
9:15	9:25	9:30	9:38	9:46	9:34	9:42	9:50	9:55	10:05
10:15	10:25	10:30	10:38	10:46	10:34	10:42	10:50	10:55	11:05
11:15	11:25	11:30	11:38	11:46	11:34	11:42	11:50	11:55	12:05
12:15	12:25	12:30	12:38	12:46	12:34	12:42	12:50	12:55	1:05
1:15	1:25	1:30	1:38	1:46	1:34	1:42	1:50	1:55	2:05
			FROM GARAGE		2:04	2:12	2:20	2:25	2:35
2:15	2:25	2:30	2:38	2:46	2:34	2:42	2:50	2:55	3:05
2:45	2:55	3:00	3:08	3:16	3:04	3:12	3:20	3:25	3:35
3:15	3:25	3:30	3:38	3:46	3:34	3:42	3:50	3:55	4:05
3:45	3:55	4:00	4:08	4:16	4:04	4:12	4:20	4:25	4:35
4:15	4:25	4:30	4:38	4:46	4:34	4:42	4:50	4:55	5:05
4:45	4:55	5:00	5:08	5:16	5:04	5:12	5:20	5:25	5:35
5:15	5:25	5:30	5:38	5:46	5:34	5:42	5:50	5:55	6:05
5:45	5:55	6:00	6:08	6:16					
6:15	6:22H	6:28	6:32	6:41	6:50	6:58	7:06H	7:11	7:20
7:30	7:37H	7:43	7:47	7:56	8:05	8:13	8:21H	8:26	8:35
8:45	8:52H	8:58	9:02	9:11	9:20	9:28	9:36H	9:41	9:50
10:00	10:07H	10:13	10:17	10:26	10:24	10:32	10:40H	10:45	10:54
11:15	11:22H	11:28	11:32	11:41	11:38	11:46	11:54H	11:59	12:08
12:30	12:37H	12:43	12:47	12:56G					
SATURDAY									
			FROM GARAGE		7:34	7:42	7:50	7:55	8:05
8:15	8:25	8:30	8:38	8:46	8:34	8:42	8:50	8:55	9:05
9:15	9:25	9:30	9:38	9:46	9:34	9:42	9:50	9:55	10:05
10:15	10:25	10:30	10:38	10:46	10:34	10:42	10:50	10:55	11:05
11:15	11:25	11:30	11:38	11:46	11:34	11:42	11:50	11:55	12:05
12:15	12:25	12:30	12:38	12:46	12:34	12:42	12:50	12:55	1:05
1:15	1:25	1:30	1:38	1:46	1:34	1:42	1:50	1:55	2:05
2:15	2:25	2:30	2:38	2:46	2:34	2:42	2:50	2:55	3:05
3:15	3:25	3:30	3:35	3:46	3:34	3:42	3:50	3:55	4:05
4:15	4:25	4:30	4:38	4:46	4:34	4:42	4:50	4:55	5:05
5:15	5:25	5:30	5:38	5:46G	5:34	5:42	5:50	5:55	6:05
6:15	6:24H	6:28	6:32	6:41	6:50	6:58	7:06H	7:11	7:20
7:30	7:39H	7:43	7:47	7:56	8:05	8:13	8:21H	8:26	8:35
8:45	8:54H	8:58	9:02	9:11	9:20	9:28	9:36H	9:41	9:50
10:00	10:09H	10:13	10:17	10:26G					

H - This trip will serve Heddington Oaks on Heading Avenue. (Nights Only)

G - To Garage

LIGHTFACE denotes A.M. times

BOLDFACE denotes P.M. times

All Seniors (65 & older) pay 50¢ per ride.