

# 5

## #5-Main

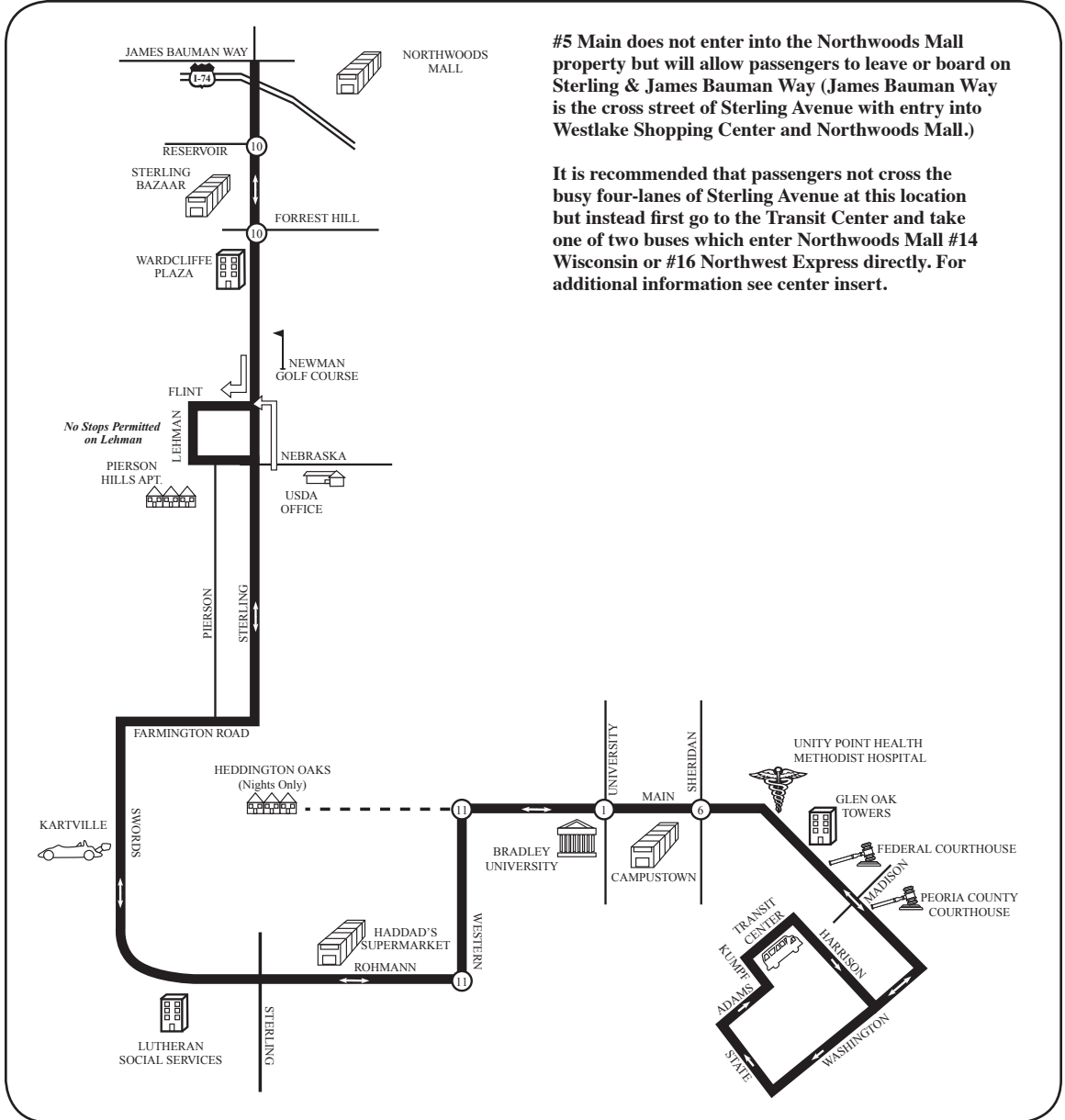

**#5 Main does not enter into the Northwoods Mall property but will allow passengers to leave or board on Sterling & James Bauman Way (James Bauman Way is the cross street of Sterling Avenue with entry into Westlake Shopping Center and Northwoods Mall.)**

**It is recommended that passengers not cross the busy four-lanes of Sterling Avenue at this location but instead first go to the Transit Center and take one of two buses which enter Northwoods Mall #14 Wisconsin or #16 Northwest Express directly. For additional information see center insert.**

# #5-MAIN

Times are approximate and may vary due to weather, road, and traffic conditions.

LEAVE TRANSIT CENTER	MAIN & UNIVERSITY	ROHMANN & STERLING	PIERSON & NEBRASKA	STERLING & BAUMAN WAY	STERLING & BAUMAN WAY	PIERSON & NEBRASKA	ROHMANN & STERLING	MAIN & UNIVERSITY	ARRIVE TRANSIT CENTER
<b>MONDAY thru FRIDAY</b>									
			FROM GARAGE		5:34	5:42	5:50	5:55	6:05
			FROM GARAGE		6:04	6:12	6:20	6:25	6:35
6:15	6:25	6:30	6:38	6:46	6:39	6:47	6:55	7:00	7:10
6:45	6:55	7:00	7:08	7:16	7:09	7:17	7:25	7:30	7:40
7:15	7:25	7:30	7:38	7:46	7:34	7:42	7:50	7:55	8:05
7:45	7:55	8:00	8:08	8:16	8:04	8:12	8:20	8:25	8:35
8:15	8:25	8:30	8:38	8:46G	8:34	8:42	8:50	8:55	9:05
8:45	8:55	9:00	9:08	9:16G					
9:15	9:25	9:30	9:38	9:46	9:34	9:42	9:50	9:55	10:05
10:15	10:25	10:30	10:38	10:46	10:34	10:42	10:50	10:55	11:05
11:15	11:25	11:30	11:38	11:46	11:34	11:42	11:50	11:55	<b>12:05</b>
<b>12:15</b>	<b>12:25</b>	<b>12:30</b>	<b>12:38</b>	<b>12:46</b>	<b>12:34</b>	<b>12:42</b>	<b>12:50</b>	<b>12:55</b>	<b>1:05</b>
1:15	1:25	1:30	1:38	1:46	1:34	1:42	1:50	1:55	2:05
			FROM GARAGE		2:04	2:12	2:20	2:25	2:35
2:15	2:25	2:30	2:38	2:46	2:34	2:42	2:50	2:55	3:05
2:45	2:55	3:00	3:08	3:16	3:04	3:12	3:20	3:25	3:35
3:15	3:25	3:30	3:38	3:46	3:34	3:42	3:50	3:55	4:05
3:45	3:55	4:00	4:08	4:16	4:04	4:12	4:20	4:25	4:35
4:15	4:25	4:30	4:38	4:46	4:34	4:42	4:50	4:55	5:05
4:45	4:55	5:00	5:08	5:16	5:04	5:12	5:20	5:25	5:35
5:15	5:25	5:30	5:38	5:46	5:34	5:42	5:50	5:55	6:05
5:45	5:55	6:00	6:08	6:16					
6:15	6:24H	6:28	6:32	6:41	6:50	6:58	7:06H	7:11	7:20
7:30	7:39H	7:43	7:47	7:56	8:05	8:13	8:21H	8:26	8:35
8:45	8:54H	8:58	9:02	9:11	9:20	9:28	9:36H	9:41	9:50
10:00	10:09H	10:13	10:17	10:26	10:24	10:32	10:40H	10:45	10:54
11:15	11:24H	11:28	11:32	11:41	11:38	11:46	11:54H	11:59	12:08
12:30	12:39H	12:43	12:47	12:56G					
<b>SATURDAY</b>									
			FROM GARAGE		7:34	7:42	7:50	7:55	8:05
8:15	8:25	8:30	8:38	8:46	8:34	8:42	8:50	8:55	9:05
9:15	9:25	9:30	9:38	9:46	9:34	9:42	9:50	9:55	10:05
10:15	10:25	10:30	10:38	10:46	10:34	10:42	10:50	10:55	11:05
11:15	11:25	11:30	11:38	11:46	11:34	11:42	11:50	11:55	<b>12:05</b>
<b>12:15</b>	<b>12:25</b>	<b>12:30</b>	<b>12:38</b>	<b>12:46</b>	<b>12:34</b>	<b>12:42</b>	<b>12:50</b>	<b>12:55</b>	<b>1:05</b>
1:15	1:25	1:30	1:38	1:46	1:34	1:42	1:50	1:55	2:05
2:15	2:25	2:30	2:38	2:46	2:34	2:42	2:50	2:55	3:05
3:15	3:25	3:30	3:35	3:46	3:34	3:42	3:50	3:55	4:05
4:15	4:25	4:30	4:38	4:46	4:34	4:42	4:50	4:55	5:05
5:15	5:25	5:30	5:38	5:46G	5:34	5:42	5:50	5:55	6:05
6:15	6:24H	6:28	6:32	6:41	6:50	6:58	7:06H	7:11	7:20
7:30	7:39H	7:43	7:47	7:56	8:05	8:13	8:21H	8:26	8:35
8:45	8:54H	8:58	9:02	9:11	9:20	9:28	9:36H	9:41	9:50
10:00	10:09H	10:13	10:17	10:26G					

H - This trip will serve Heddington Oaks on Heading Avenue. (Nights Only)

G - To Garage

LIGHTFACE denotes A.M. times

**BOLDFACE** denotes P.M. times

**All Seniors (65 & older) pay 50¢ per ride.**