

11

#11-Western

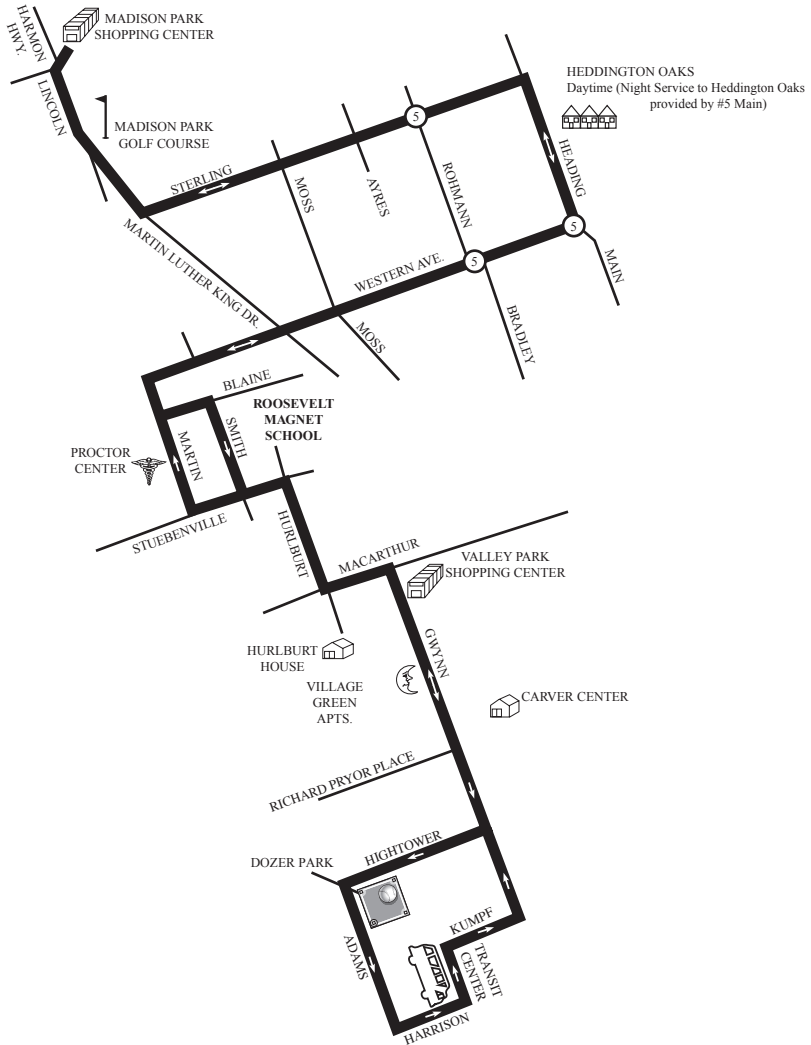

☞ Late night service via #13 S. Adams.

#11-WESTERN

Times are approximate and may vary due to weather, road, and traffic conditions.

LEAVE
TRANSIT
CENTER

MARTIN
& BLAINE

HEADING &
STERLING

ARRIVE
MADISON
PARK

LEAVE
MADISON
PARK

STERLING &
HEADING

SMITH &
BLAINE

ARRIVE
TRANSIT
CENTER

MONDAY thru FRIDAY

FROM GARAGE				5:43	5:49	5:56	6:10
6:15	6:22	6:27	6:33	6:13	6:19	6:26	6:40
6:45	6:52	6:57	7:03	6:43	6:49	6:56	7:10
7:15	7:22	7:27	7:33	7:13	7:19	7:26	7:40
7:45	7:52	7:57	8:03	7:43	7:49	7:56	8:10
8:15	8:22	8:27	8:33	8:13	8:19	8:26	8:40
8:45	8:52	8:57	9:03G	8:43	8:49	8:56	9:10
9:15	9:22	9:27	9:33	9:13	9:19	9:26	9:40
10:15	10:22	10:27	10:33	10:43	10:49	10:56	11:10
11:15	11:22	11:27	11:33	11:43	11:49	11:56	12:10
12:15	12:22	12:27	12:33	12:43	12:49	12:56	1:10
1:15	1:22	1:27	1:33	1:43	1:49	1:56	2:10
FROM GARAGE				2:13	2:19	2:26	2:40
2:15	2:22	2:27	2:33	2:43	2:49	2:56	3:10
2:45	2:52	2:57	3:03	3:13	3:19	3:26	3:40
3:15	3:22	3:27	3:33	3:43	3:49	3:56	4:10
3:45	3:52	3:57	4:03	4:13	4:19	4:26	4:40
4:15	4:22	4:27	4:33	4:43	4:49	4:56	5:10
4:45	4:52	4:57	5:03	5:13	5:19	5:26	5:40
5:15	5:22	5:27	5:33	5:43	5:49	5:56	6:10
5:45	5:52	5:57	6:03G				
6:15	6:22	6:27	6:33G				

SATURDAY

FROM GARAGE				7:43	7:49	7:56	8:05
8:15	8:22	8:27	8:33	8:43	8:49	8:56	9:05
9:15	9:22	9:27	9:33	9:43	9:49	9:56	10:05
10:15	10:22	10:27	10:33	10:43	10:49	10:56	11:05
11:15	11:22	11:27	11:33	11:43	11:49	11:56	12:05
12:15	12:22	12:27	12:33	12:43	12:49	12:56	1:05
1:15	1:22	1:27	1:33	1:43	1:49	1:56	2:05
2:15	2:22	2:27	2:33	2:43	2:49	2:56	3:05
3:15	3:22	3:27	3:33	3:43	3:49	3:56	4:05
4:15	4:22	4:27	4:33	4:43	4:49	4:56	5:05
5:15	5:22	5:27	5:33G				

Night Service to Heddington Oaks provided on #5 Main.

G - To Garage

LIGHTFACE denotes A.M. times

BOLDFACE denotes P.M. times

All Seniors (65 & older) pay 50¢ per ride.